

ITEM NO.	PART NUMBER	DESCRIPTION	MATERIAL	QTY
1	1460HB	60" HIGH BACK QUICK-TACH BUCKET	REFER PARTS DETAILS	1
2	1400-22HBTK-ASSY	SKYTRAK HB BUCKET QT ASSY	REFER PARTS DETAILS	1
3	D12125	DBFC 5/8" X8" X62 7/8" BLADE W/10 HOLES	ASTM A36 STEEL	1
4	BOB-01B	5/8-11 X 2 1/2" UNC PLOW BOLT-GRADE 5	STEEL	10
5	BOB-01N	NYLON INSERT LOCKNUT, 5/8-11 UNC	STEEL	10

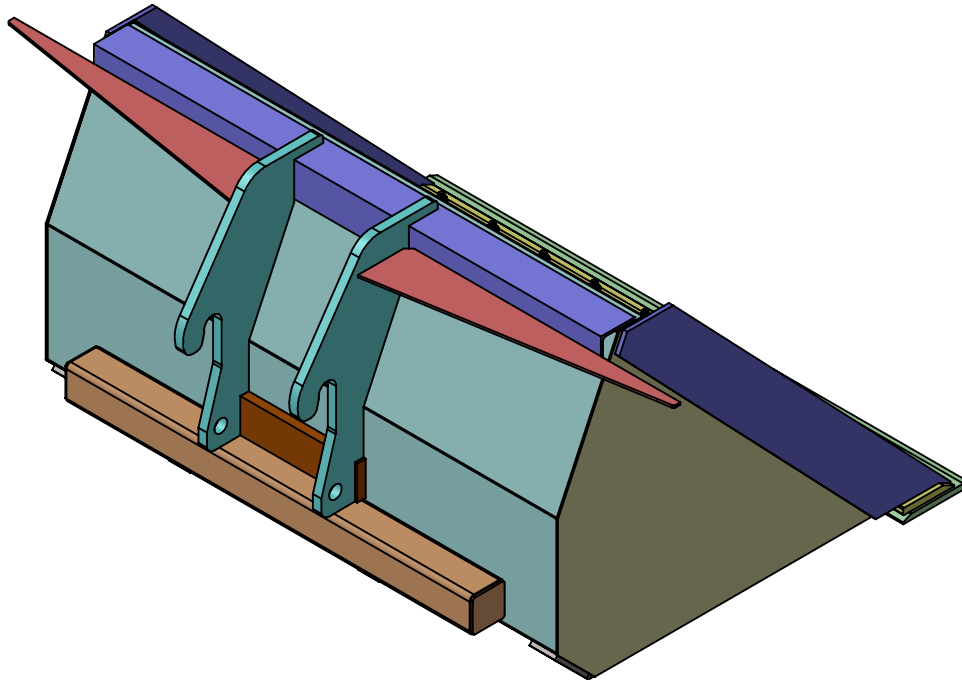

**1460HB-TK  
60" HIGH BACK SKYTRAK COMPATIBLE  
QUICK-TACH BUCKET**

**PROPRIETARY AND CONFIDENTIAL**  
THE INFORMATION CONTAINED IN THIS DRAWING IS THE SOLE PROPERTY OF STAR INDUSTRIES. ANY REPRODUCTION IN PART OR AS A WHOLE WITHOUT THE WRITTEN PERMISSION OF STAR INDUSTRIES IS PROHIBITED.

UNLESS OTHERWISE SPECIFIED:

DIMENSIONS ARE IN INCHES  
TOLERANCES:  $\pm 1/16$   
FRACTIONAL  $\pm$   
ANGULAR: MACH  $\pm$  BEND  $\pm$   
TWO PLACE DECIMAL  $\pm$   
THREE PLACE DECIMAL  $\pm$

INTERPRET GEOMETRIC TOLERANCING PER:  
MATERIAL REFER PARTS DETAILS  
FINISH

DO NOT SCALE DRAWING

	NAME	DATE
DRAWN	HI-TECH	8/3/2019
CHECKED		
ENG APPR.		
MFG APPR.		
Q.A.		
COMMENTS:		



**STAR INDUSTRIES**

TITLE:  
**60" HIGH BACK SKYTRAK  
COMPATIBLE QUICK-TACH BUCKET**

SIZE <b>A</b>	DWG. NO. 1460HB-TK-DLR	REV <b>0</b>
------------------	---------------------------	-----------------

SCALE: 1:16    WEIGHT: 882.96 LBS    SHEET 1 OF 2

5

4

3

2

1

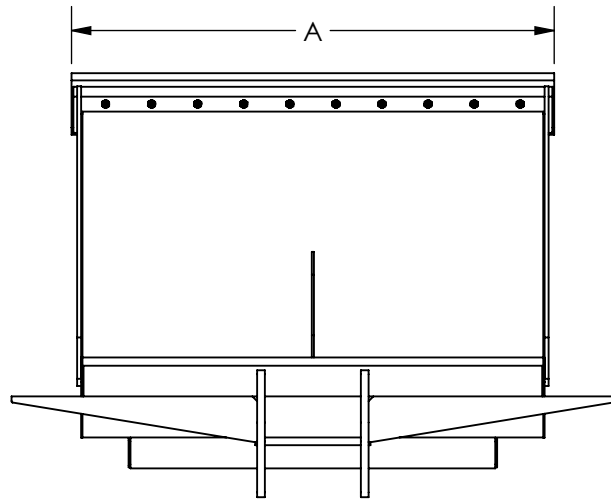

## 1460HB-TK 60" HIGH BACK SKYTRAK COMPATIBLE QUICK-TACH BUCKET

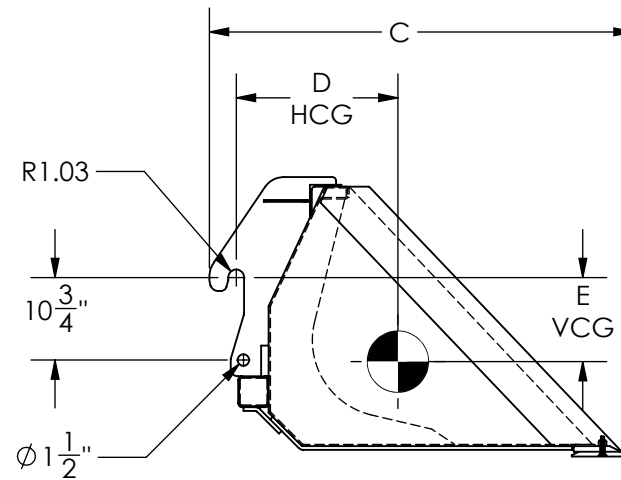
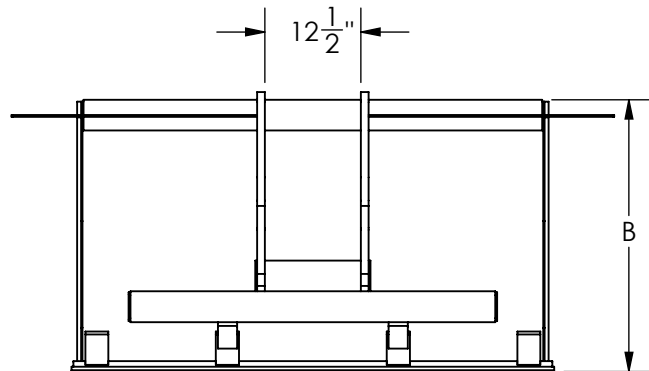

MODEL NO	A	B	C	D	E	BUCKET VOLUME	BUCKET LOAD CAPACITY	EMPTY WEIGHT	LOADED HORZ CG	LOADED VERT CG
1460HB-TK	62 7/8"	35 3/8"	56 3/16"	21 1/16"	10 15/16"	1.0 CYD	3500 LBS	882.96 LBS	16 7/8"	8 1/4"

**ALL SKYTRAKS, MOST JLG TELEHANDLERS MANUFACTURED AFTER OCT 2008, GENIE 6K & 8K , JCB WITH NARROW QUICK-TACH, XTREME MODELS XR842, XR1045, XR1245, XR1055, XR1147, XR1245, XR1255, XR1270, XR1470, SR9244, & SR1054. 12.5" BETWEEN THE EARS**

SIZE <b>A</b>	DWG. NO. 1460HB-TK-DLR	REV <b>0</b>
SCALE: NTS	WEIGHT: 882.96 LBS	SHEET 2 OF 2

5

4

3

2

1