

**LP22A-72T LOW PROFILE  
72" SKID-STEER BUCKET**

**PROPRIETARY AND CONFIDENTIAL**  
THE INFORMATION CONTAINED IN THIS  
DRAWING IS THE SOLE PROPERTY OF  
STAR INDUSTRIES. ANY  
REPRODUCTION IN PART OR AS A WHOLE  
WITHOUT THE WRITTEN PERMISSION OF  
STAR INDUSTRIES IS PROHIBITED.

UNLESS OTHERWISE SPECIFIED:
DIMENSIONS ARE IN INCHES
TOLERANCES: $\pm 1/16$
FRACTIONAL $\pm$
ANGULAR: MACH $\pm$ BEND $\pm$
TWO PLACE DECIMAL $\pm$
THREE PLACE DECIMAL $\pm$
INTERPRET GEOMETRIC TOLERANCING PER:
MATERIAL REFER PARTS DETAILS
FINISH
DO NOT SCALE DRAWING

	NAME	DATE
DRAWN	HI-TECH	12/20/2019
CHECKED		
ENG APPR.		
MFG APPR.		
Q.A.		
COMMENTS:		



**STAR INDUSTRIES**

TITLE:

LP22A-72T LOW PROFILE  
72" SKID-STEER BUCKET

SIZE <b>A</b>	DWG. NO. LP22A-72T-DLR	REV <b>0</b>
SCALE: 1:12	WEIGHT: 581.77 LBS	SHEET 1 OF 2

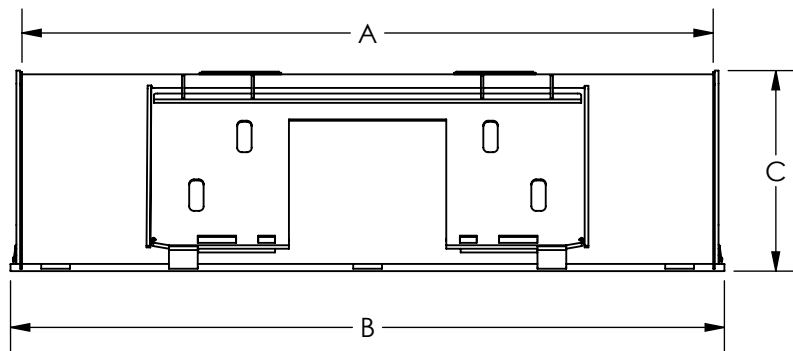
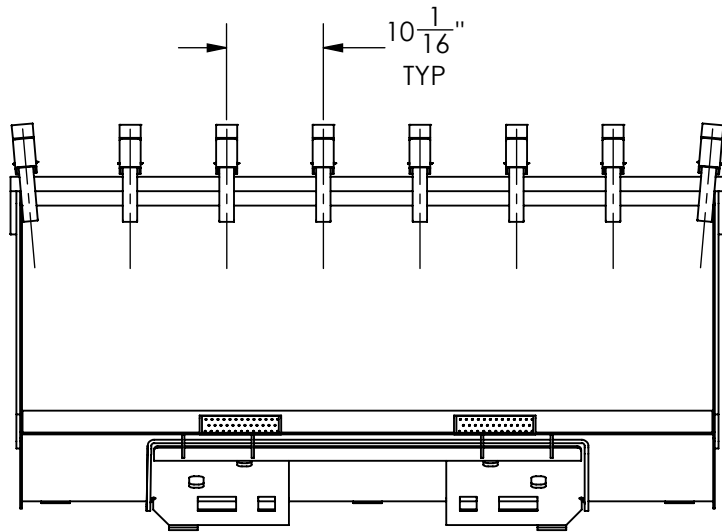

# **LP22A-72T LOW PROFILE 72" SKID-STEER BUCKET**

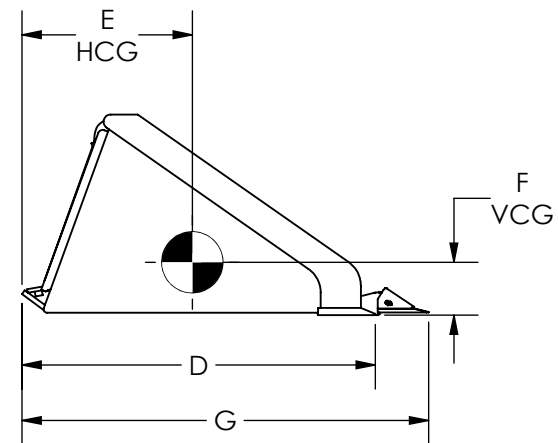

MODEL NO	A	B	C	D	E	F	G	HEAPED CAPACITY (CYD)	EMPTY WEIGHT
LP22A-72T	72"	74 3/8"	20 7/8"	36 13/16"	17 3/4"	5 1/2"	42 3/8"	10.22	581.77 LBS

SIZE <b>A</b>	DWG. NO. LP22A-72T-DLR	REV <b>0</b>
SCALE: 1:20	WEIGHT: 581.77 LBS	SHEET 2 OF 2